

5

4

3

2

1

ZONE	REV	DESCRIPTION	DATE
B		DR HOLE WAS 4.5	9/13/2003
C		ADDED #4-40 HOLES	9/16/2003
D		Added radial pattern of coing	1/27/2004

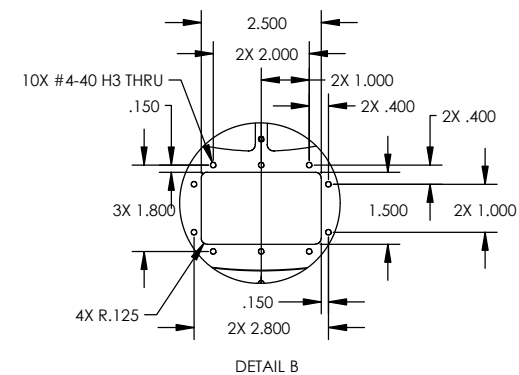
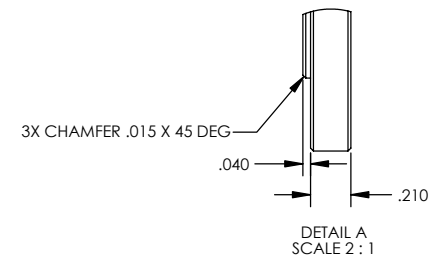
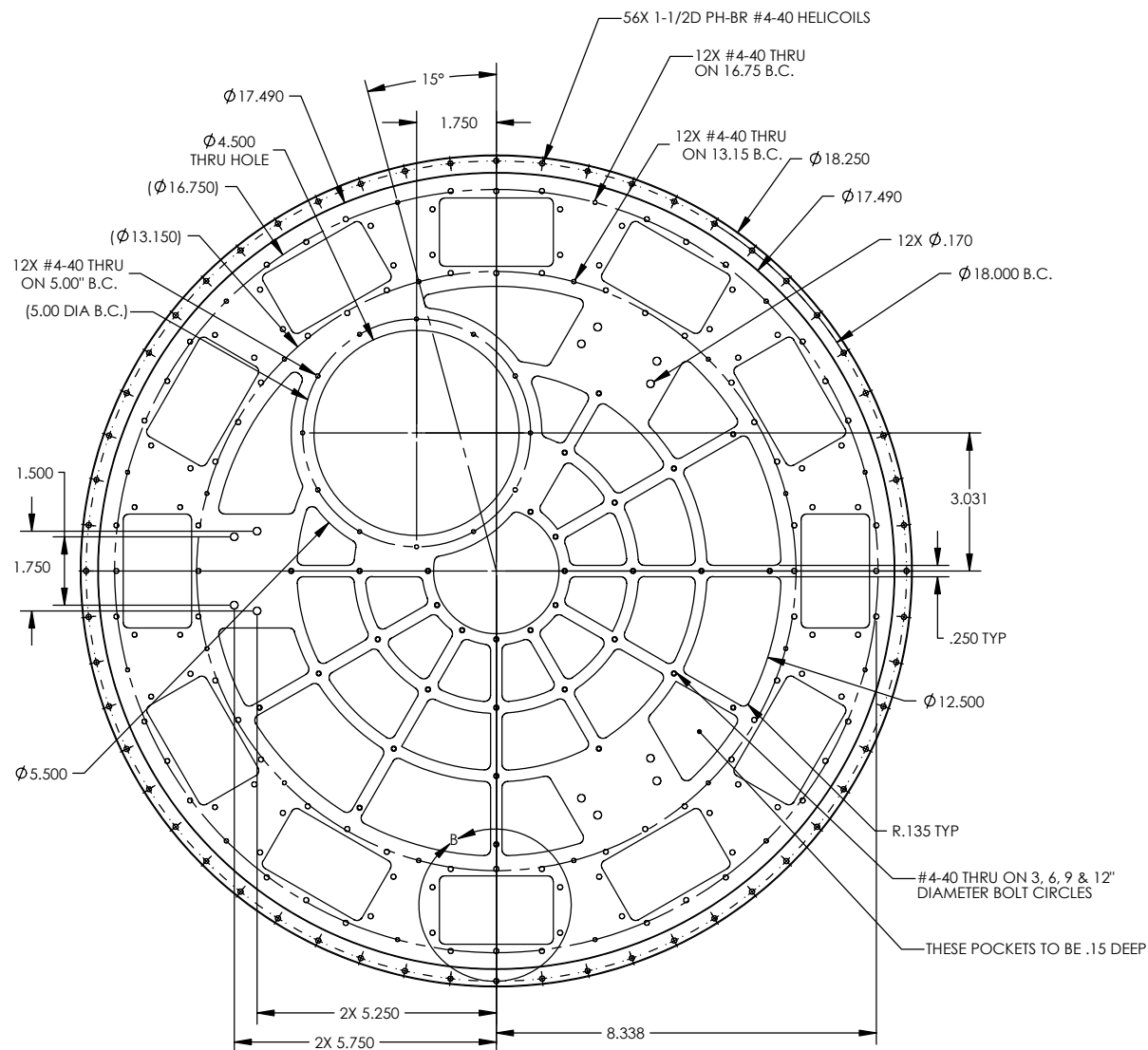

NOTES:
1. FOUR-HOLE PATTERN TO BE ROTATED EVERY 120 DEGREES.

UNLESS OTHERWISE SPECIFIED:				
DIMENSIONS ARE IN INCHES				
DECIMAL TOLERANCES:				
X	±.030	.XX	±.015	.XXX ±.005
ANGULAR TOL: ±1° SURFACE ROUGHNESS: .25				
INTERNAL AND EXTERNAL SURFACE:				
INTERSECTIONS SHALL BE UNIFORMLY FINISHED WITH CHAMFER .005/.010 X 45° OR RADIUS .005/.010				
CHAMFER ALL THREADED HOLES 110% OF MAJOR DIAMETER X 45°				
MATERIAL: OF Copper				
FINISH: N/A				

High Precision Devices

1668 Valtrec Lane, Suite C, Boulder, Colorado 80301
Phone: (303) 447-2558 Fax: (303) 447-2548 Web Site: www.hpd-online.com

TITLE:
p02101-136 .6K top plate

CONFIGURATION: **00-Default**

SIZE	QTY PER ASSM:	SCALE:	SHEET	OF	REV
C	1	1:2	1	OF 1	D
DATE:	5/19/2004	DRAWN BY:	C. Danaher		